

SERIES 980S

REDESIGNED FOR
LED_s

ONE, TWO, OR THREE LED BOARDS



Lamping Options

LED	T8
(1 - 3) 48"	(2) 32w (48")
(2 - 6) 96"	(4) 32w (96")

Application

- Open office ambient lighting for virtually glare free and shadow free illumination.
- Indirect/Direct suspended lighting fixture; Indirect is 70% and direct is 30%.
- The direct component is controlled by 3" wide semi-specular aluminum baffles standard or opaque overlay (by others).
- This unit is designed for LED or T8
- Fixture will also accept T8 LED tubes.
- Designed for low brightness illumination for general office or classroom applications where 85 to 90% efficiency is needed. All reflectors necessary for performance are supplied as standard.

Finishes

- Unpainted/unfinished formed steel housings with center slotted openings.
- Customer to source a local powder coating facilities to paint steel housings and die cast aluminum end caps.
- An internal ballast bracket assembly is included with precoated white steel and shipped as an assembly with lamp holder brackets and adjustable ballast mounting.
- Reflectors are enhanced aluminum for maximum efficiency for direct and indirect control.

Features

- Fixtures are shipped with die cast aluminum joiners for structural integrity and suspension continuity.
- Fixtures are designed to mount on exact 4 foot and 8 foot centers. Joiners will accept stems, single cable, "V" cable, and power cords as supplied by others.
- Architectural ends. This die cast aluminum end comes standard with a scoop styled configuration. Ends are bolted to the die cast joiners for a complete architectural look.
- Housing can be differentiated by specifying perforations on the bottom sides parallel to the center slot.
- Fixture can be modified to accept daylight and/or motion detectors.
- Fixture is 9-5/8" wide by 2-1/2" high.

Optional Features

- The housings are roll formed which allows custom lengths with predictable results. Units could also be used in a wall mounted version. Please contact factory for any optional feature.
- Custom modifications in the physical specification and color are available for this fixture.

Packaging	4'	8'
Bodies	36	36

Specifications subject to change without notice.



Adam Metal Products Company • P.O. Box 450 • Ledgewood, NJ • 07852
Phone: 973.770-1100 • Fax 973.770-1105 • www.adammetal.com



SERIES 980S

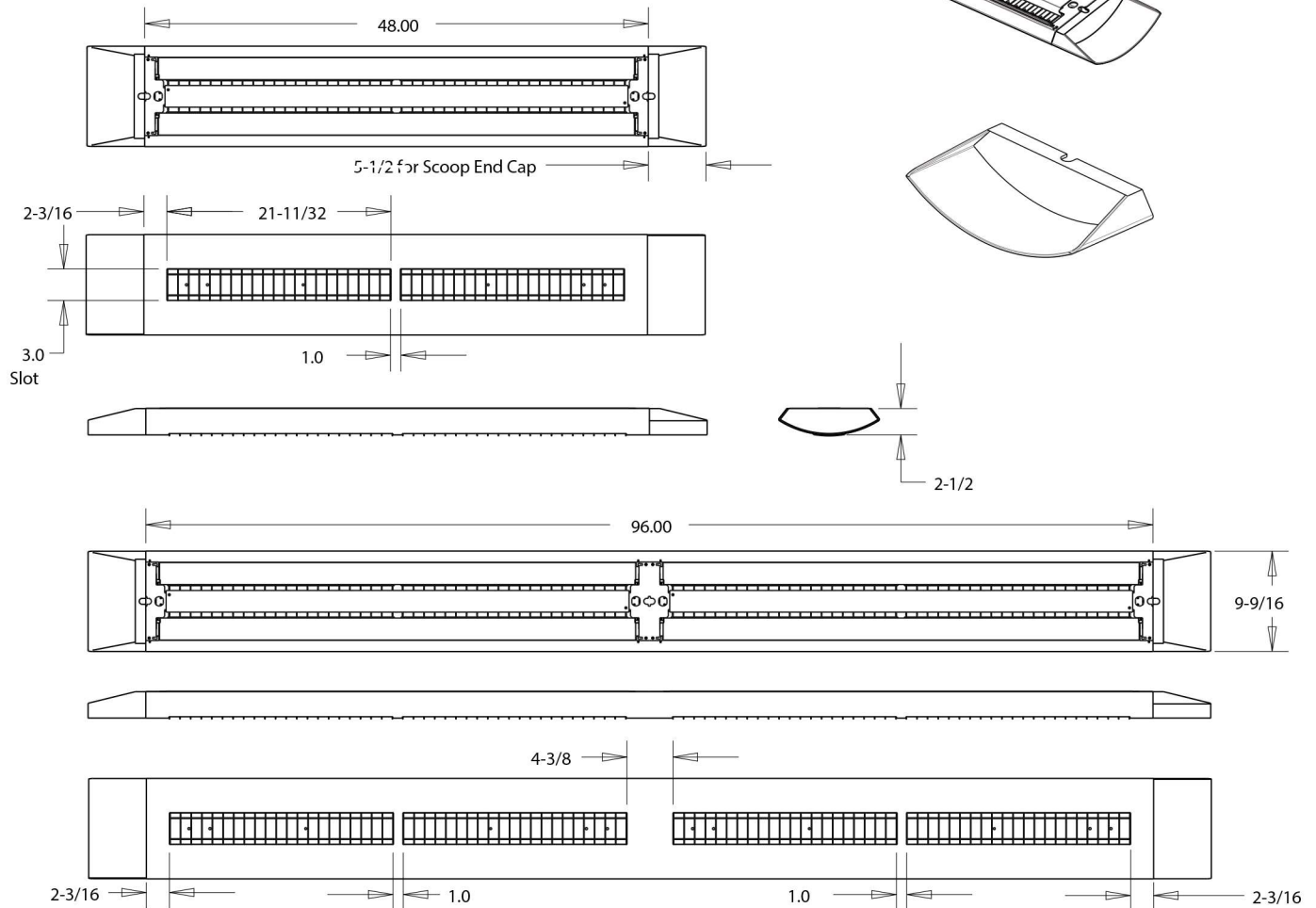
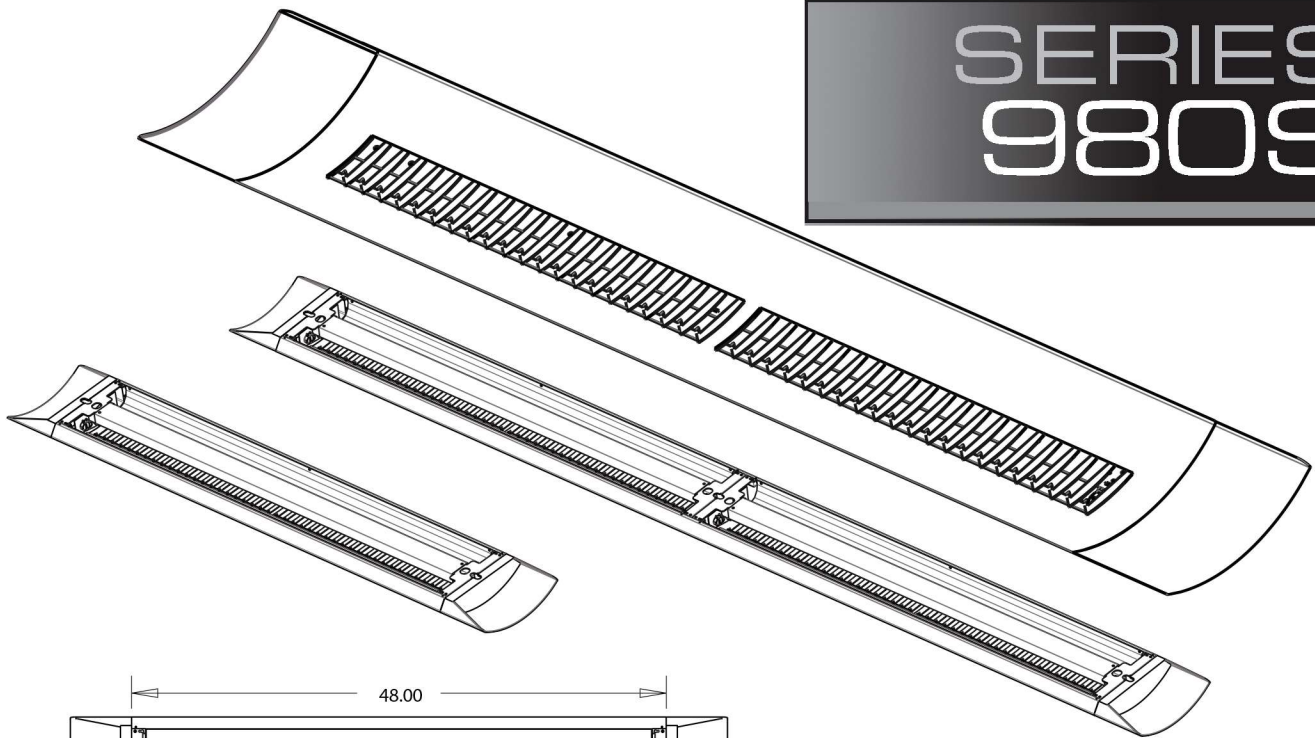

LED	
BOARDS	LENGTH
1 - 3	48"
2 - 6	96"

T8	
SIZE	LENGTH
(2) 32w	48"
(4) 32w	96"

Add 5-1/2" for each end cap

Rev 5-20-2020



Adam Metal Products Company • P.O. Box 450 • Ledgewood, NJ • 07852
Phone: 973.770-1100 • Fax 973.770-1105 • www.adammetal.com





Adam Metal Products Company

Series 950S / 980S Center Slotted Linear 4-foot Assembly Instructions

950S / 980S 4ft ASSEMBLY

HARDWARE LIST (by others)

- (A) 8-32 X 1/4" Long Machine Screw (4 Pcs.)
- (B) 1/4 - 20 X 3/4" Long Allen Head Screw (4 Pcs.)
- (C) #8 X 1/4" Screw (6 Pcs.)

ASSEMBLY INSTRUCTIONS

- 1.) Mount End Cap to Body with (B)
- 2.) Insert Baffle Assembly (Snaps into 3" slots)
- 3.) Install both Side Reflectors with (C)
- 4.) Install Ballast Assembly with (A).

NOTE:

Peel off all protective coating on reflectors.

NOTE:

If running continuous string of bodies, connect bodies together with (B) to each Joiner. At the end of the run mount End Cap. Make sure each Joiner has a suspension system.

All suspension systems to be supplied by others.

Warning:

Each Joiner must have a suspension system.

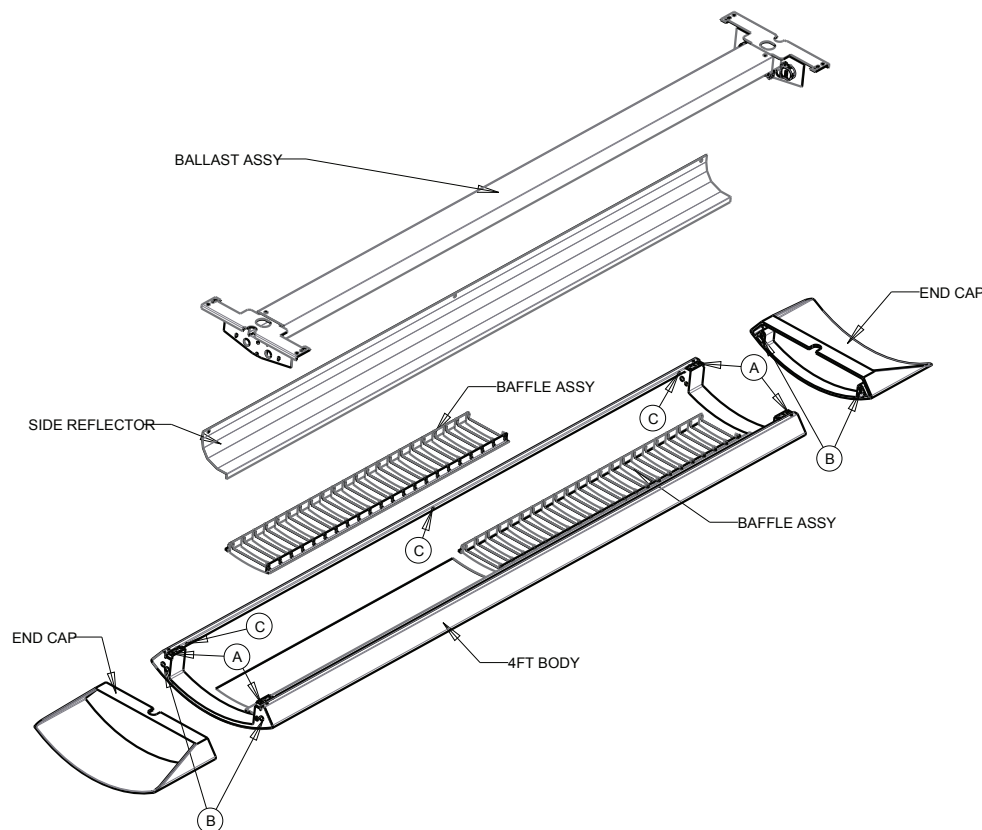

NOTE:

When attaching the Bodies together for continuous runs use the inside holes on the Joiner.



Adam Metal Products Company • P.O. Box 450 • Ledgewood, NJ • 07852
Phone: 973.770.1100 • Fax: 973.770.1105 • www.adammetal.com





Adam Metal Products Company

Series 950S / 980S Center Slotted Linear 8-foot Assembly Instructions

950S / 980S 8ft ASSEMBLY

HARDWARE LIST (by others)

- (A) 8-32 X 1/4" Long Machine Screw (4 Pcs.)
- (B) 1/4 - 20 X 3/4" Long Allen Head Screw (4 Pcs.)
- (C) #8 X 1/4" Screw (6 Pcs.)

ASSEMBLY INSTRUCTIONS

- 1.) Mount End Cap to Body with (B)
- 2.) Insert Baffle Assembly (Snaps into 3" slots)
- 3.) Install Side Reflectors with (C)
- 4.) Install Ballast Assembly with (A).

NOTE:

Peel off all protective coating on reflectors.

NOTE:

If running continuous string of bodies, connect bodies together with (B) to each Joiner. At the end of the run mount End Cap. Make sure each Joiner has a suspension system.

All suspension systems to be supplied by others.

Warning:

Each Joiner must have a suspension system.

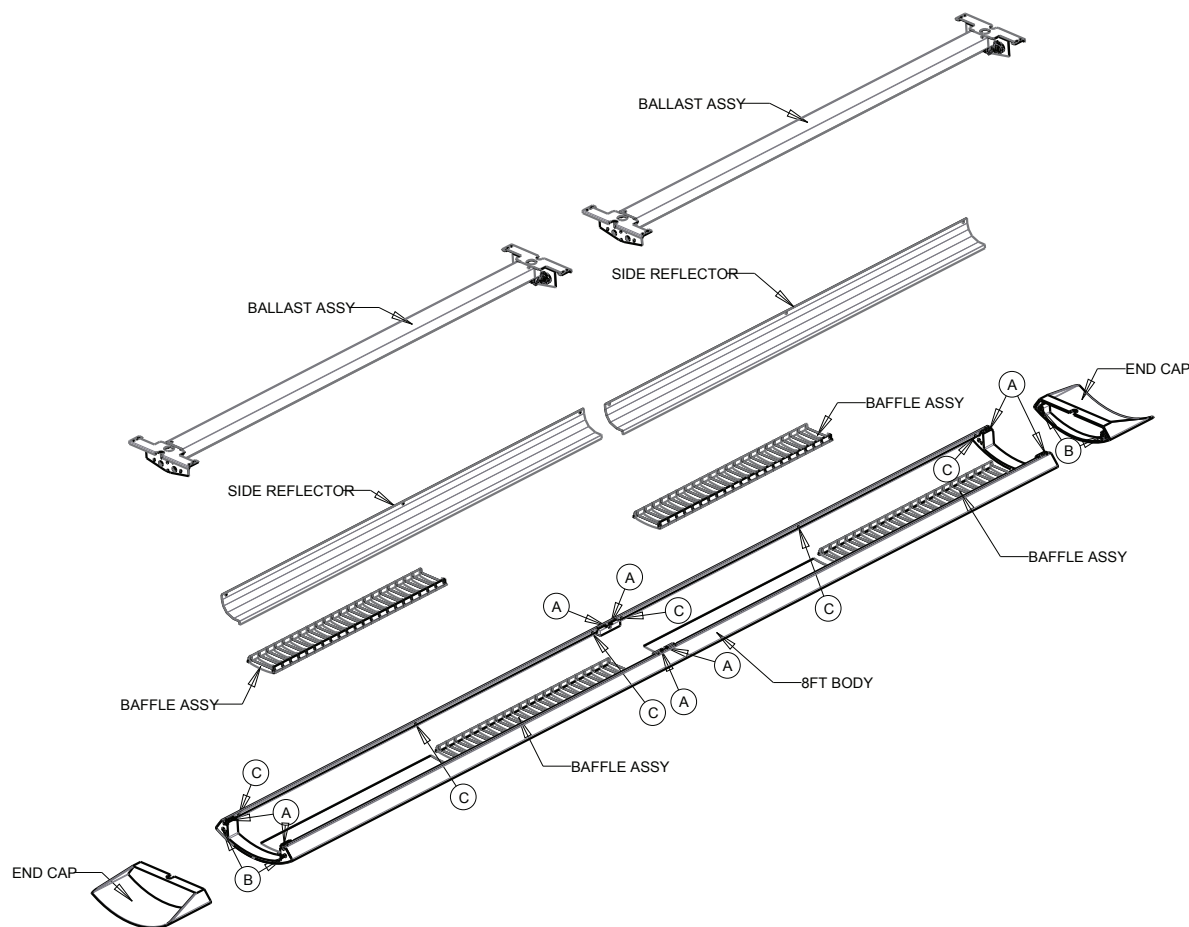

NOTE:

When attaching the Bodies together for continuous runs use the inside holes on the Joiner.



Adam Metal Products Company • P.O. Box 450 • Ledgewood, NJ • 07852
Phone: 973.770.1100 • Fax: 973.770.1105 • www.adammetal.com





Adam Metal Products Company

Series 950S / 980S Center Slotted Linear Ballast Assembly Instructions

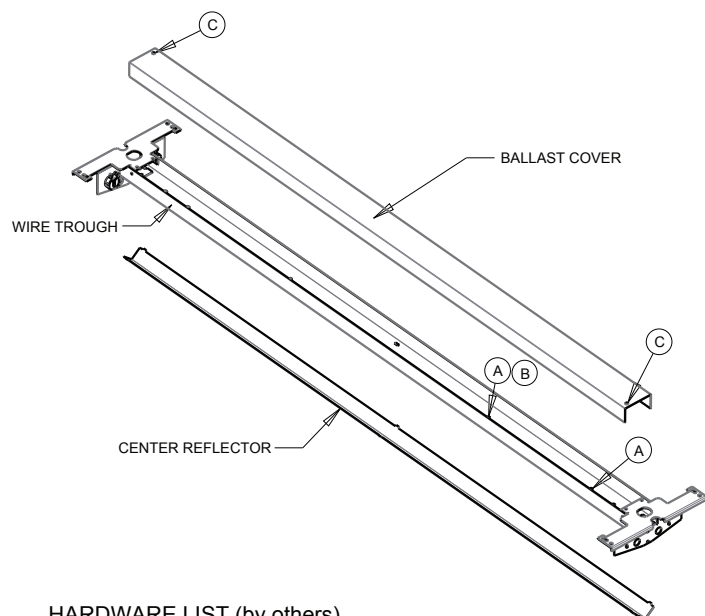

HARDWARE LIST (by others)

- (A) 8-32 Capped Washer Type Lock Nut (3 PCS)
(Palnut Company Cat.# D0832075)
- (B) 8-32 X 3/8" Long Screw
- (C) #8 X 1/4" Screw

RECOMMENDED SOCKETS

600V Rotary G5
Vossloh Schwabe - 108663
Stucchi - 285/FAU
BJB - 26.641.2001.50

LAMP SOCKETS
(BY OTHERS)

SOCKET PLATE

950S BALLAST ASSEMBLY

CENTER REFLECTOR

LAMP SOCKETS
(BY OTHERS)

SOCKET PLATE

ASSEMBLY INSTRUCTIONS

- 1.) Attach Ballast to the 8-32 Stud provided in the Wire Trough with 8-32 Lock Nut (A).
- 2.) Attach other end of Ballast to the hole provided in the Wire Trough with 8-32 Screw & Lock Nut (A & B).
- 3.) Snap in Lamp Holders to the Socket Plate, use standard at one end and spring back at the other end.
- 4.) Attach Ballast Cover to Wire Trough (C).
- 5.) Install Center Reflector to back of Trough using the tab and slots provided.

Note: If using 3 Lamps do not use Center Reflector.
3rd Lamp will replace Center Reflector down the center of the Trough.



Adam Metal Products Company • P.O. Box 450 • Ledgewood, NJ • 07852
Phone: 973.770.1100 • Fax: 973.770.1105 • www.adammetal.com

